

NUKEPROOF

STEM INSTALLATION INSTRUCTIONS

THANK YOU FOR SELECTING A NUKEPROOF HORIZON STEM.

With proper care and installation, it will give you trouble-free, enjoyable use. To maximise the safe enjoyment of this product, you should read and carefully follow the following installation instructions. Failure to do so could result in unexpected wear or failure, possibly resulting in injury. We recommend having your parts fitted by a qualified bicycle mechanic. Nukeproof assumes no responsibility for malfunction or injury due to faulty installation.

TOOLS REQUIRED:

- 4mm Allen Key
- Torque Wrench

BOLT TORQUE VALUES:

- Steerer Clamp: 6Nm
- Faceplate: 5Nm

INSTALLATION INSTRUCTIONS:

Remove faceplate and loosen steerer bolts on the stem. Check that fork steerer tube is cut cleanly then slide the stem onto the steerer tube. Spacers can be added above or below the stem to get your desired height but ensure that the steerer sits 2-3mm below the top of the stem or spacer.

This stem has been designed with 5mm rise so it can be fitted giving +/- 5mm.

Install the top cap and bolt then tighten to pre-load the headset bearings. Care should be taken to ensure that all play has been removed from the headset and that steering rotation is smooth. This bolt should only be tightened until all play is gone.

Re-install the two steerer clamp bolts, ensure stem is straight then tighten bolts to 6Nm torque.

Fit the handlebars into the stem then loosely install the two top clamp bolts, when you are happy the handlebar is in the correct position tighten the top bolts to 5nm torque. You should alternate between the bolts when tightening. There should be "No Gap" between the top of the face plate and the stem.

Install the bottom 2 bolts and tighten to 5Nm torque.

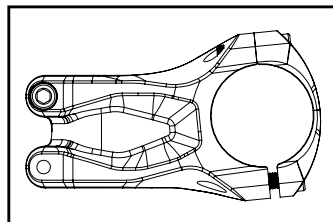
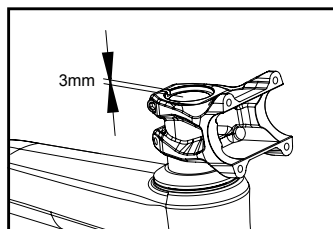

MAINTENANCE

Regularly check that the stem bolts are tight and there are no signs of damage to the stem. Only tighten bolts using a torque wrench to the correct torque value.

"LIMITED WARRANTY"

Nukeproof warrants this product to be free from defects in materials and workmanship for a two-year period from the date of original retail purchase. This warranty is extended only to the original owner of the product. Proof of purchase is required for any warranty service, so be sure to keep your receipt.

For full warranty terms and conditions visit <http://nukeproof.com/warranty/>